

# APEXA™ G Installation Guide

Please assemble this optional device after turning off the system and disassembling the adapter from the pos terminal. Please see the video from the [www.posbank.com](http://www.posbank.com)

## ■ 2nd Display (9.7", 12.1", 15" & CDP)

### 1. Package contents

The following items are included when you purchase this product. If any of these items are damaged or missing, contact your dealer for assistance.

#### [Packing list]

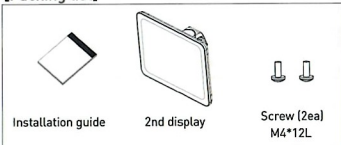

### 2. Setup optional item

#### 1. Separate I/O cover.

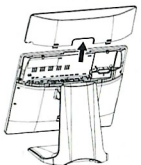

#### 2. 2nd display is assembled on the stand. [M4X12L]

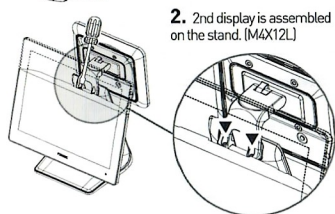

#### ※ I/O port

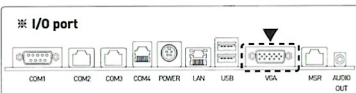

#### 3. Connect the cable of 2nd display after refer to the image.

### BIOS Setting



#### 4. While booting POS device, press [Delete] key and enter into BIOS mode. Select [Chipset →] South Bridge



#### 5. Change VGA 12V Configuration - Disabled to Enabled.

#### 6. Press the [F4] key to save and exit.

#### 7. Confirm the system operation.

#### 8. Assemble "I/O Cover".

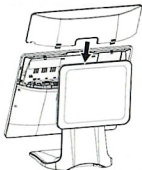

※ BIOS setup is not necessary for CDP.

#### ※ 2nd display Switch setting

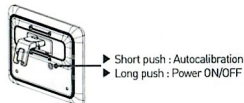

## ■ MSR (SCR, I-button)

### 1. Package contents

The following items are included when you purchase this product. If any of these items are damaged or missing, contact your dealer for assistance.

#### [Packing list]

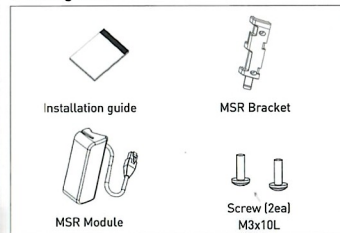

### 2. Setup optional item

#### 1. Separate I/O cover.

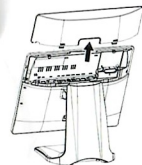

#### 2. Fix the MSR bracket using screws to the back of monitor.

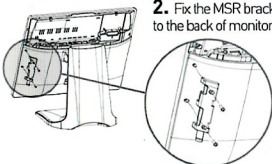

#### 3. Put MSR module in the MSR bracket.

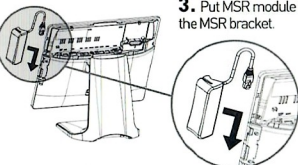

#### 4. Connect the cable to MSR port. Attention : Please arrange it after referring to the cable image.

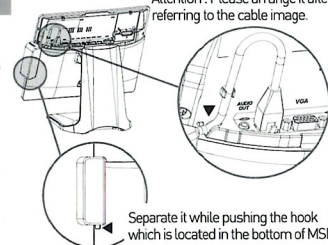

Separate it while pushing the hook which is located in the bottom of MSR.



#### 5. Click on the [www.posbank.com](http://www.posbank.com) and search and download the MSR mapper.

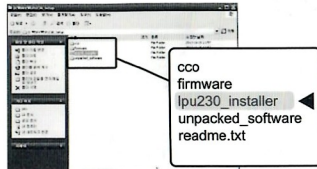

#### 6. Execute the lpu230\_installer.

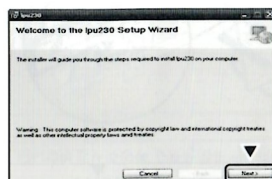

#### 7. Please install the program according to the instruction.

#### 8. After finishing the downloading chose the [select device] to check it is installed well.

#### 9. Assemble "I/O Cover".

# Bracket wall mount

## 1. Package contents

The following items are included when you purchase this product. If any of these items are damaged or missing, contact your dealer for assistance.

### [Packing list]

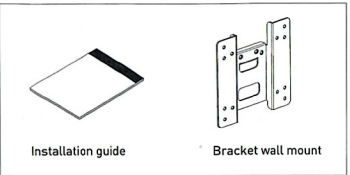

## 2. Setup optional item

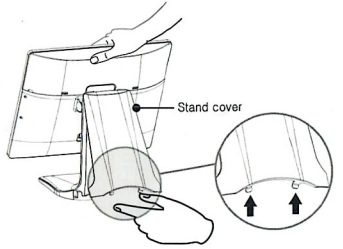

1. Separate it while holding the product of the handle & pulling the bottom hook of "stand cover".

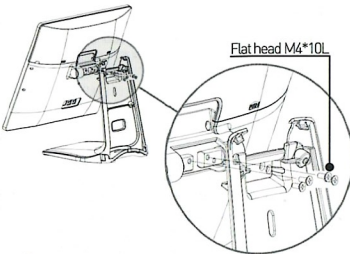

2. Separate four screws (Flat head M4\*10L).  
 ※ Reuse the screws (Flat head M4\*10L).  
 ※ In some cases, Provide the screws.

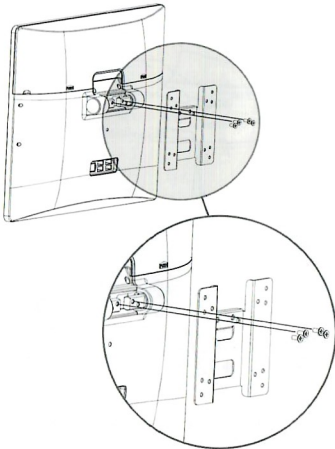

3. Assemble "Bracket wall mount" with the screws (Flat head M4\*10L).  
 4. Reference to the Wall mount (purchases) manual.

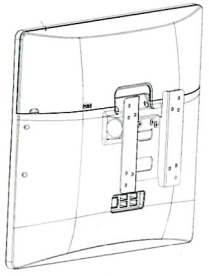

※ Reference

# Arrangement of the cable

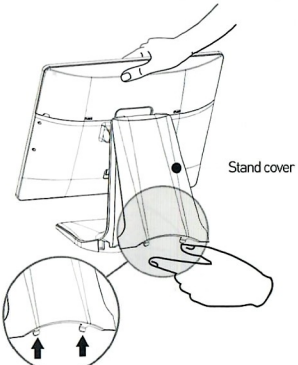

1. Separate it while holding the product of the handle & pulling the bottom hook of "stand cover".

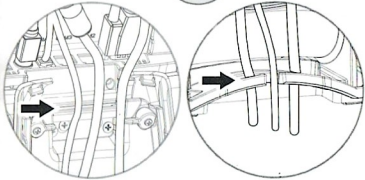
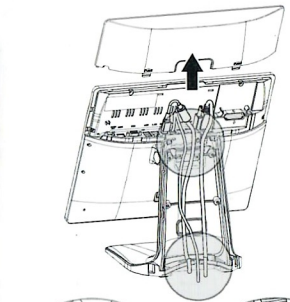

2. Separate "I/O cover".  
 3. Please arrange it after referring to the cable image.

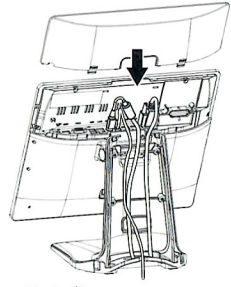

4. Assemble the I/O cover.

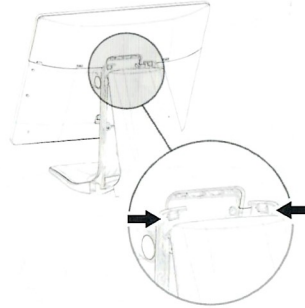

5. Assemble upper and push the bottom.

## ● Warning

### Instruction for low reliability or fire/electric shock/damage

1. Do not disassemble or remodeling the products except professional engineer.
2. Do not pour water or liquid into the system.  
 - Call to your close service center, if liquid getting inside of the product.
3. Ground the product before install the system.
4. Do not touch AC power during extreme thunder storm.
5. Do not touch AC power with wet hand.
6. Do not pull AC power or other peripheral device cables.
7. If abnormal smell, sound, or smoke is occurred, remove AC power immediately and call to your close service center.
8. Do not use damaged AC power or plug (outlet).
9. Keep away the product and vinyl package from children.  
 - Children can be choked, if they pull the vinyl over their head.